

CONDOR mod. R

BALER FOR IRON SCRAP TREATMENT

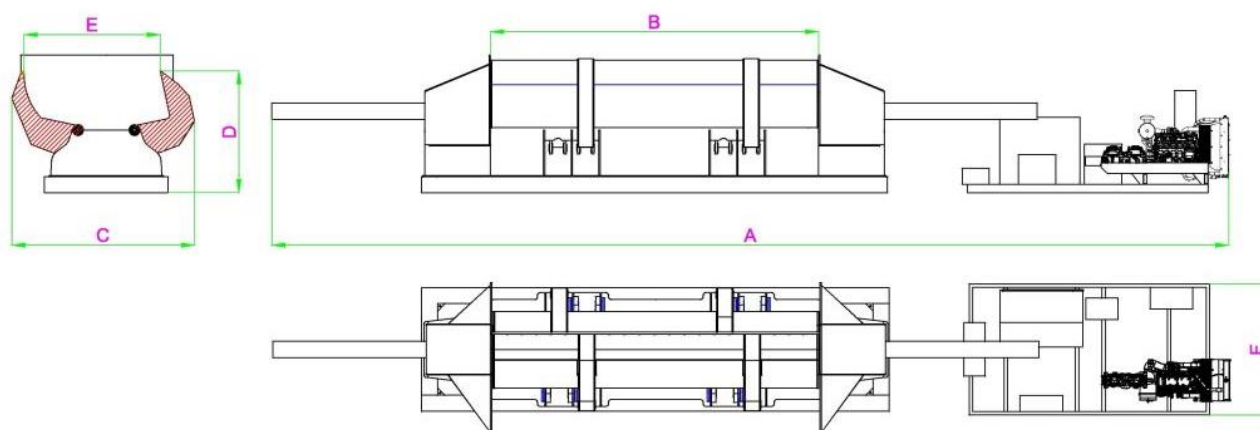

BALER – STANDARD CONFIGURATION

BALER CONDOR mod. R - DIMENSION	
TOTAL LENGTH (A)	~18000 mm
COMPRESSION BOX LENGTH (B)	6000 mm
WIDTH (C)	3045 mm
CHARGING HEIGHT (D)	2220 mm
COMPRESSION BOX WIDTH (with wings open) (E)	2300 mm
WIDTH DURING TRANSPORT PHASE (F)	2500 mm
BALER (standard configuration) WEIGHT	44000 kg

BALER CONDOR mod. R - TECHNICAL SPECIFICATIONS	
➤ PRE-COMPRESSION BOX	
- Oscillating wings with internal crossing cylinders (wings and base are made in anti-wear steel Hardox – structural)	Yes
- Box length	6100 mm
- Opened box width	2300 mm
- Bale's dimensions	800x600 mm
- Cylinders on each wing	2
- Max. compression force on each wing	250 t
- Pre-compression box lubrication	Manual
- Steel base frame height	300 mm
➤ FEEDING	
- Longitudinal compression cylinder (max compression force)	2x140 t
➤ HYDRAULIC UNIT	
- Constant power piston pump (variable output)	2 x K3V140
- Pump for oil cooling and filtering	90 l/min
- Piloting pump	6 l/min
- Hydraulic oil tank	1500 l
- Hydraulic distributor	Yes
- Security valve	Internal
- Valve for feeding cylinder fast oil discharge	Internal
- Oil filtering system after the pump	Yes
- Oil filtering circuit on the return	Yes
- Oil filtering system on piloting pump	Yes
- Air/oil cooling	Yes
- Max pressure	350 bar
➤ POWER UNIT	
- Diesel version <ul style="list-style-type: none"> • Iveco diesel engine 	129kW (172hp)
- Electric version <ul style="list-style-type: none"> • Electric motor 	110kW (147.5hp)
➤ ELECTRONIC UNIT	
- PLC + radio remote control + electric cabinet with touch screen display	

➤ **OPTIONAL ON DEMAND**

- Warning acoustic signal system (siren)
 - Cold climate package
 - Operator cab with control consolle
 - Operator cab climate package
 - Platform and stairs
 - Pre-load hopper
 - Sound proofing for diesel engine
 - Jack – lift system equipped with four swinging cylinders (height 1100 mm)
 - Wireless modem + repeater hub + antenna
- or
- 2G/3G Wireless modem + antenna

➤ **PRODUCTION**

- Light material or vehicle body : 1 bale each 1'35"
- Medium/Heavy material: 1 bale each 1'40"

Please note that: the stated production rates are indicative and could change according to:

- the size and type of the material,
- the capacity of loading,
- as well as the ability of the operator.

